

IQ BUILDER



Coloring
Puzzle



HOUSE ASSEMBLY INSTRUCTIONS

- 1) POP OUT ALL 3D PUZZLE PIECES FROM PUZZLE CARD
- 2) COLOR IN ALL 3D PUZZLE PIECES BEFORE ASSEMBLY (COLOR 50%-75% FOR BEST RESULTS)
- 3) ASSEMBLE 3D PUZZLE BY CONNECTING 3D PUZZLE PIECES ACCORDING TO DIAGRAM BELOW

PUZZLE PIECES

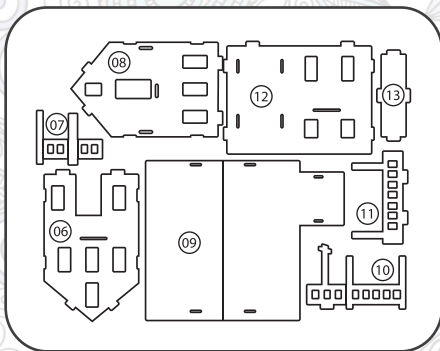
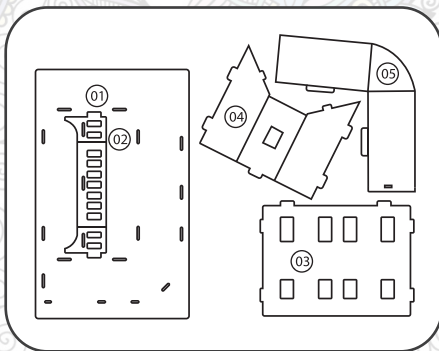

ASSEMBLY STEPS

